

VORON2 2.4R2 CNC BUILD GUIDE

We build space shuttles with gardening tools
so anyone can have a space shuttle of their own.

Feng Hai 2022-05-25

Note:
This tutorial is adapted from the official
printout of the tutorial, the pictures are
different, for installation reference only.

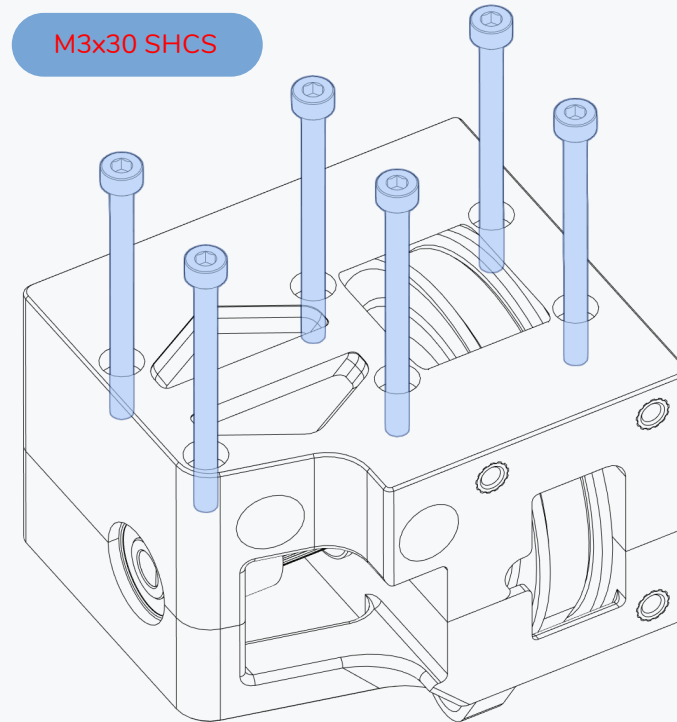
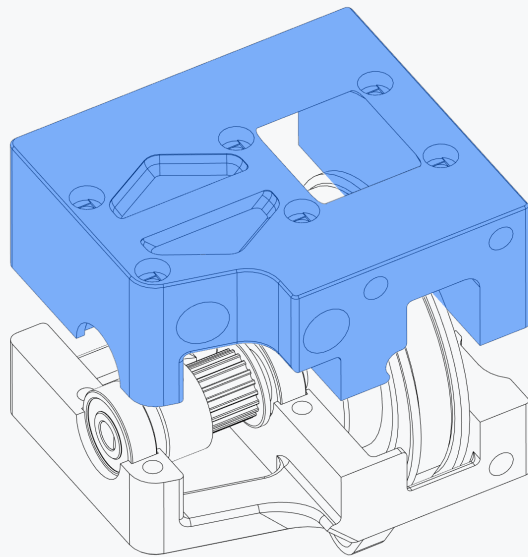

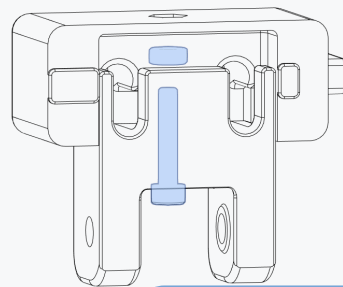
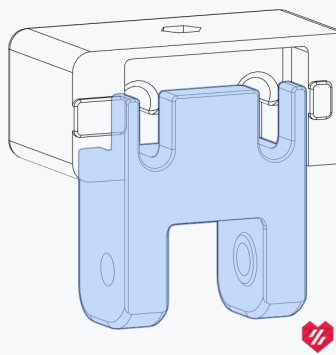
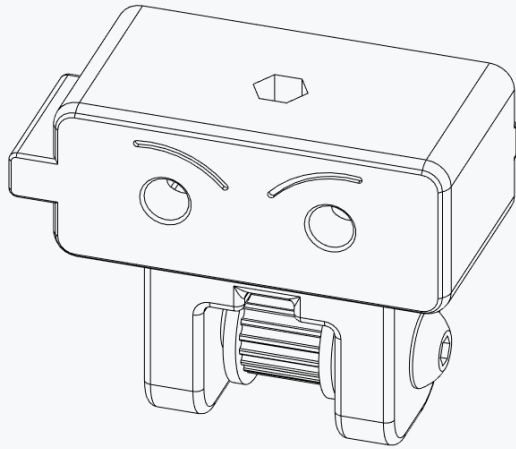

M3x16 SHCS

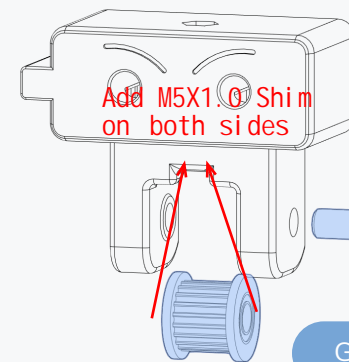

M5x30 BHCS

GT2 20 Tooth Idler 9mm wide

RIGHT XY JOINT

CABLE PATH

The printed parts for the right XY joint have a small channel to guide the end stop wires..

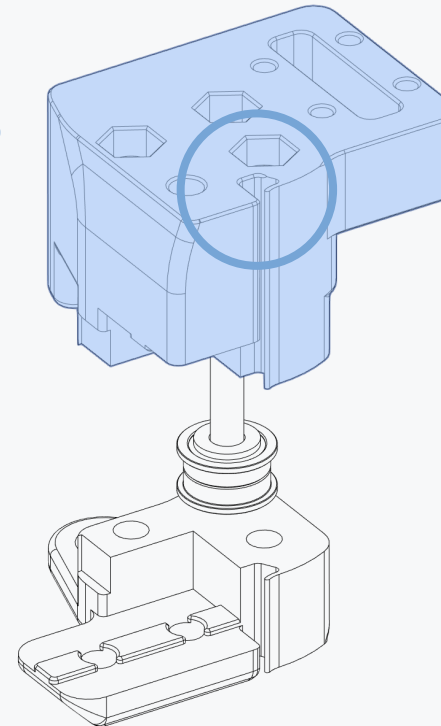
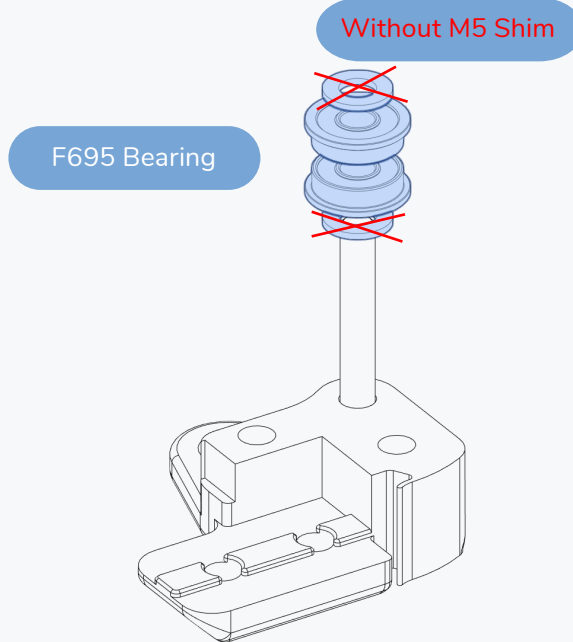
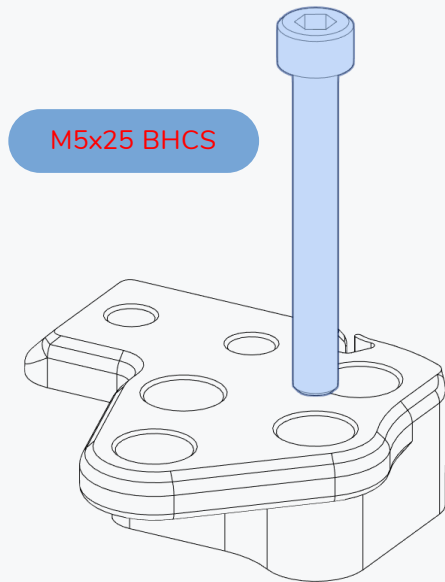
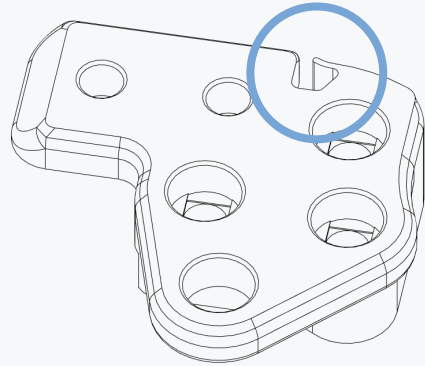

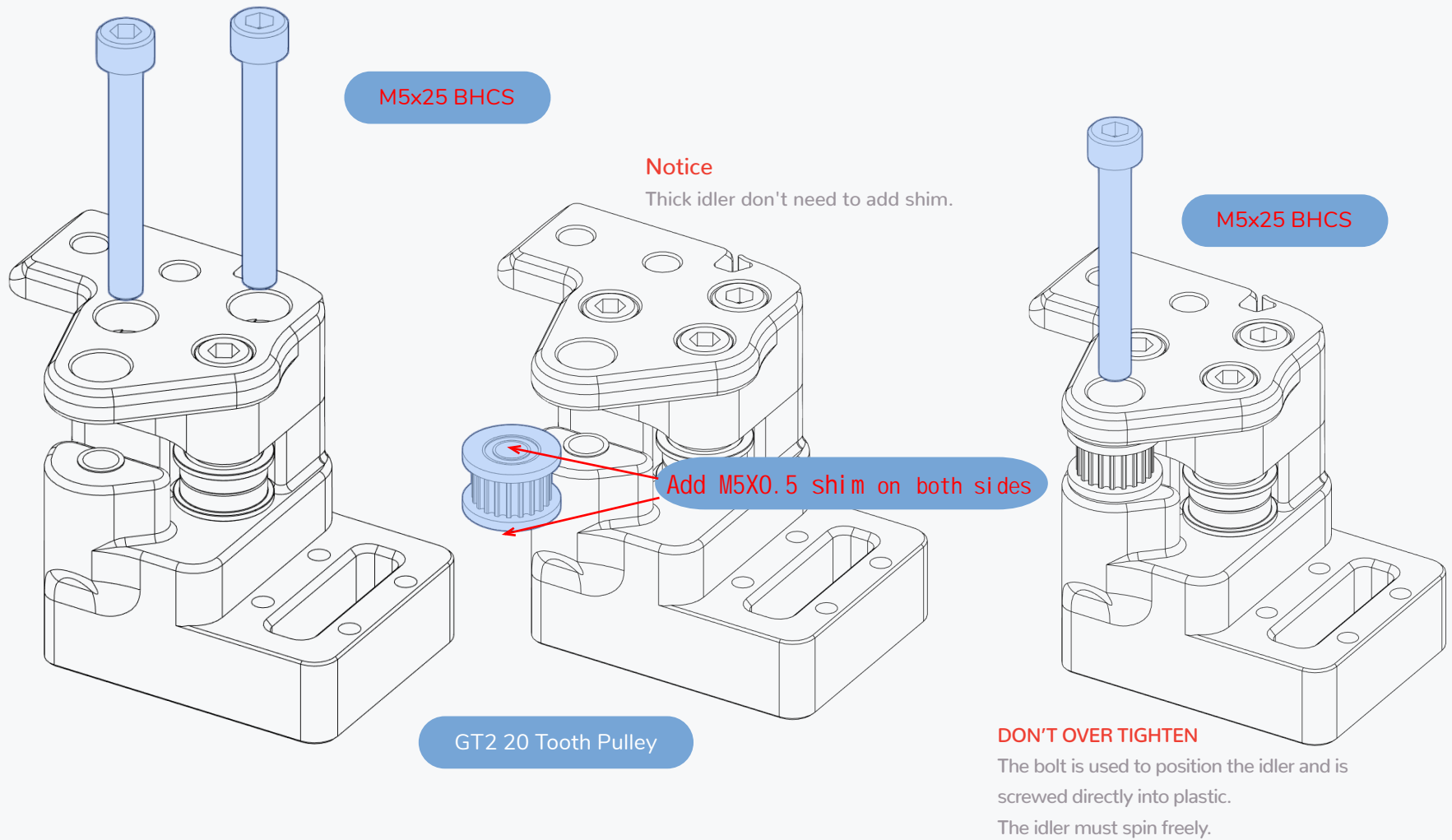

LEFT XY JOINT

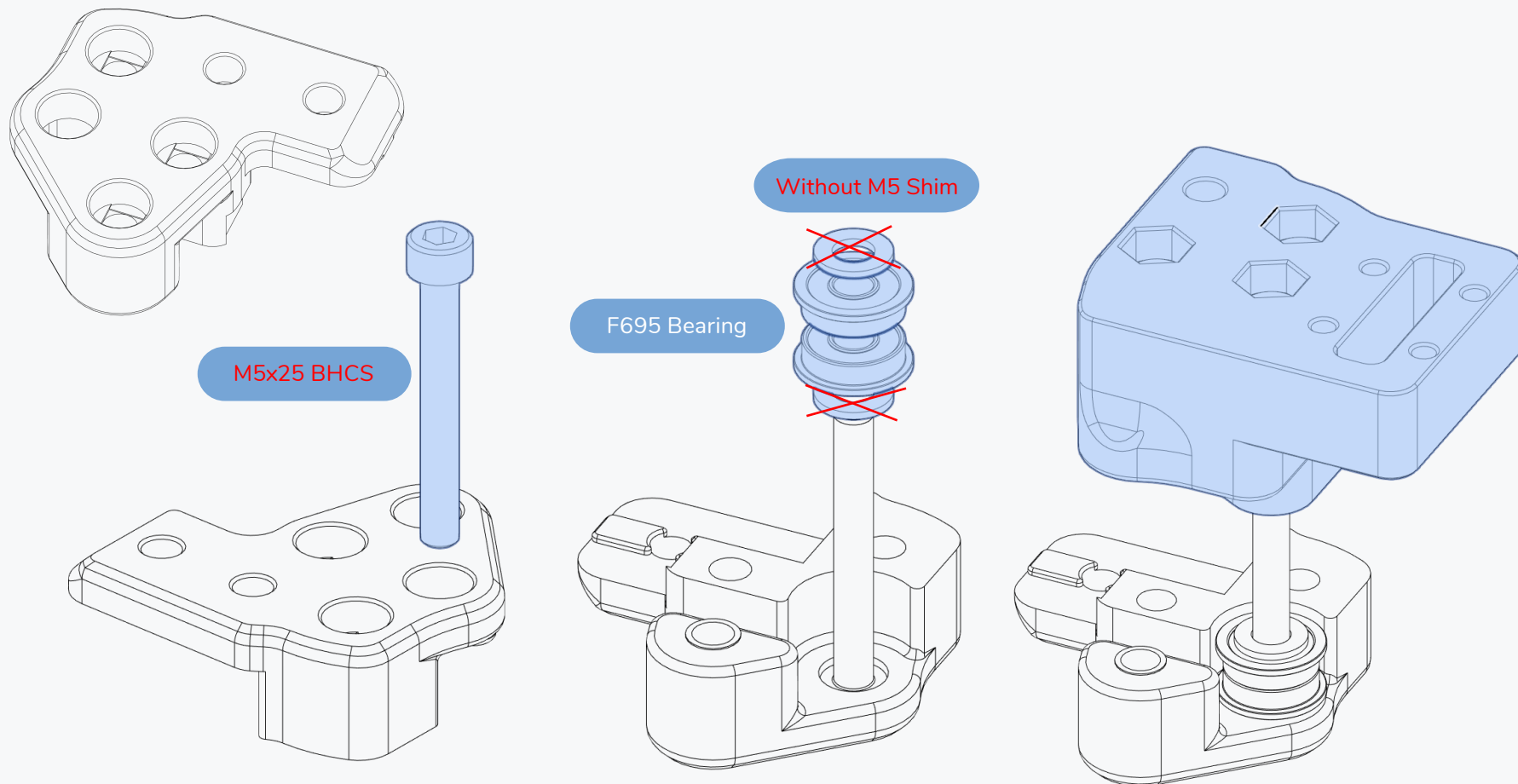

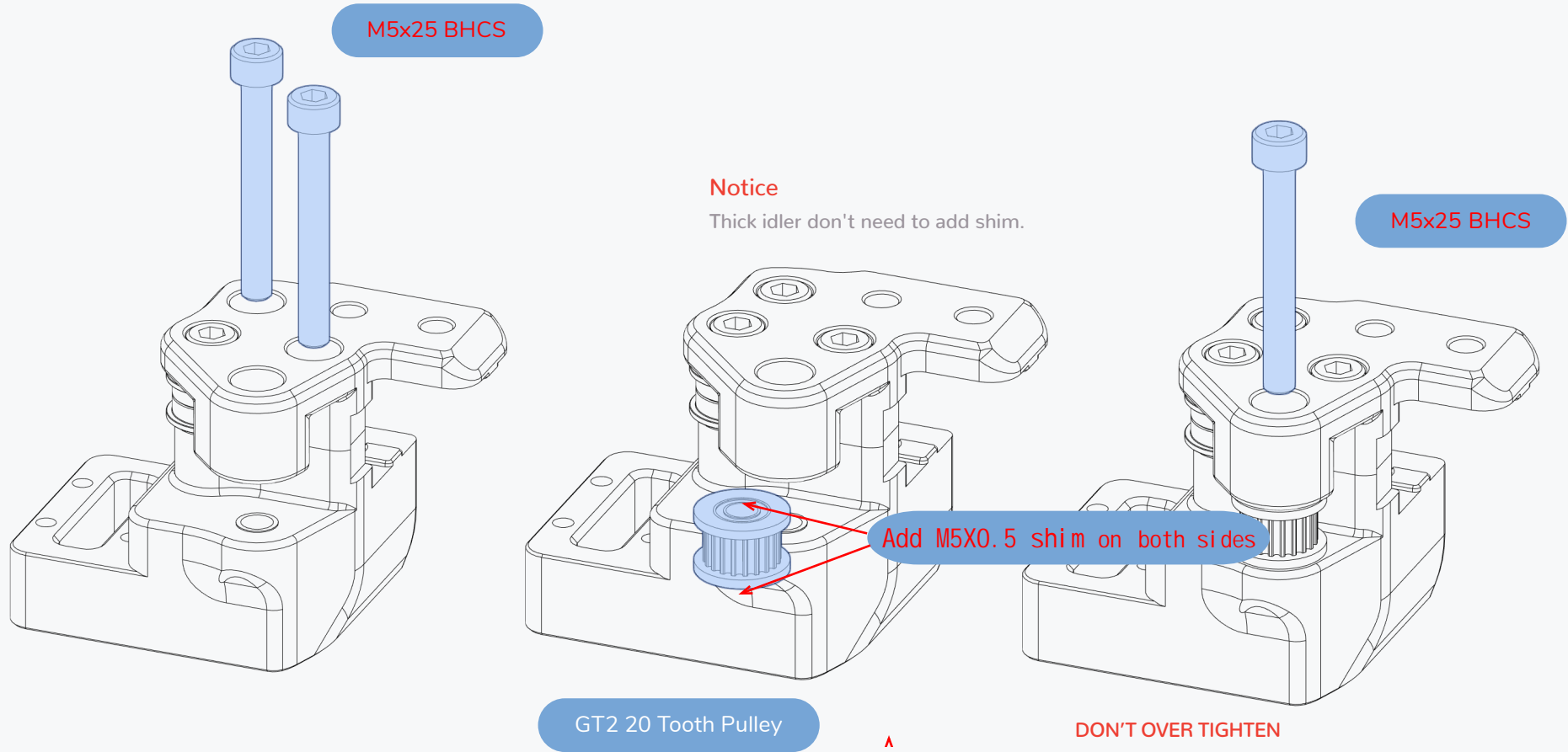

DON'T OVER TIGHTEN
The bolt is used to position the idler and is screwed directly into plastic. The idler must spin freely.

X AXIS

WWW.VORONDESIGN.COM

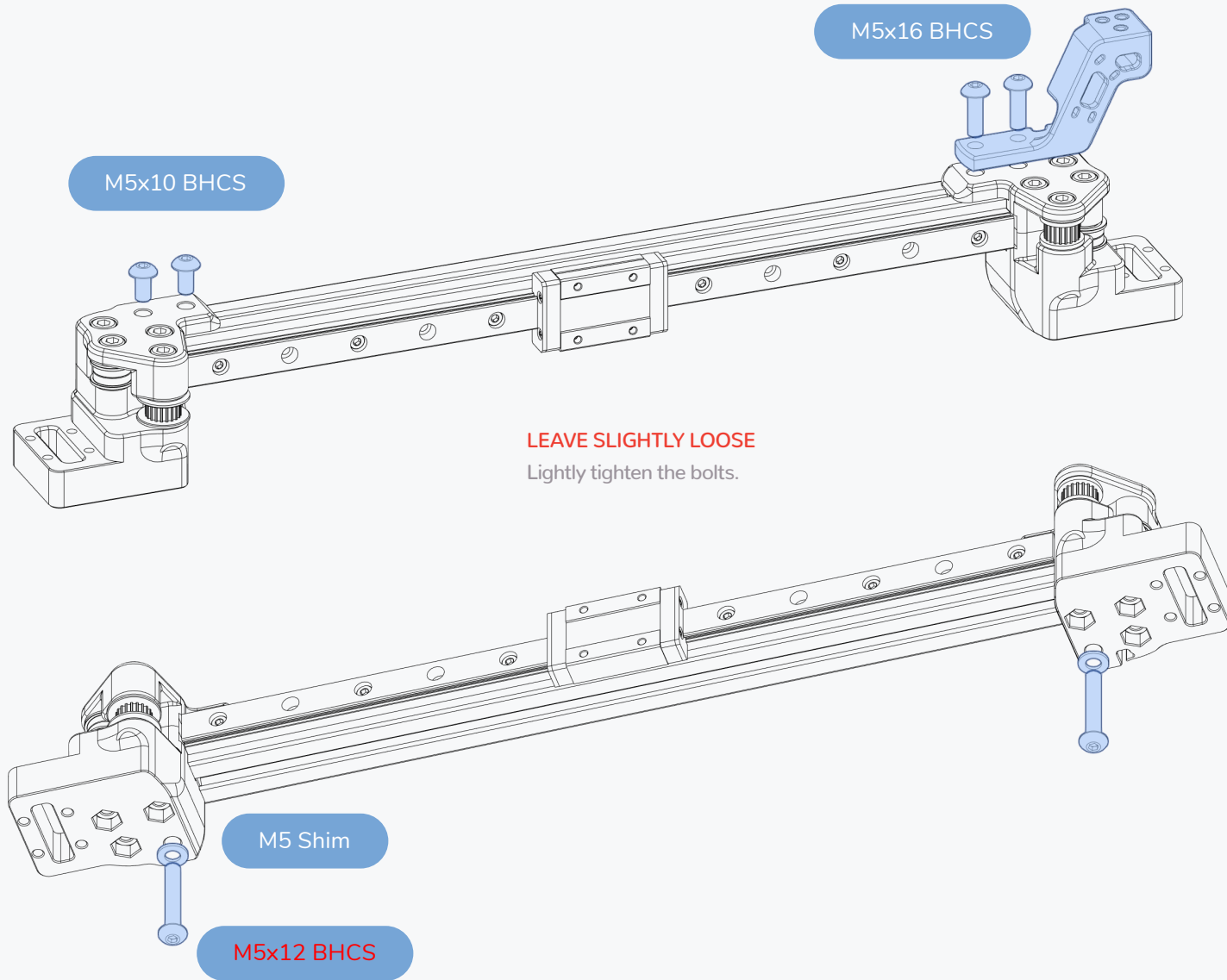

GANTRY

WWW.VORONDESIGN.COM

FLIP GANTRY

Turn the gantry around for the next step.

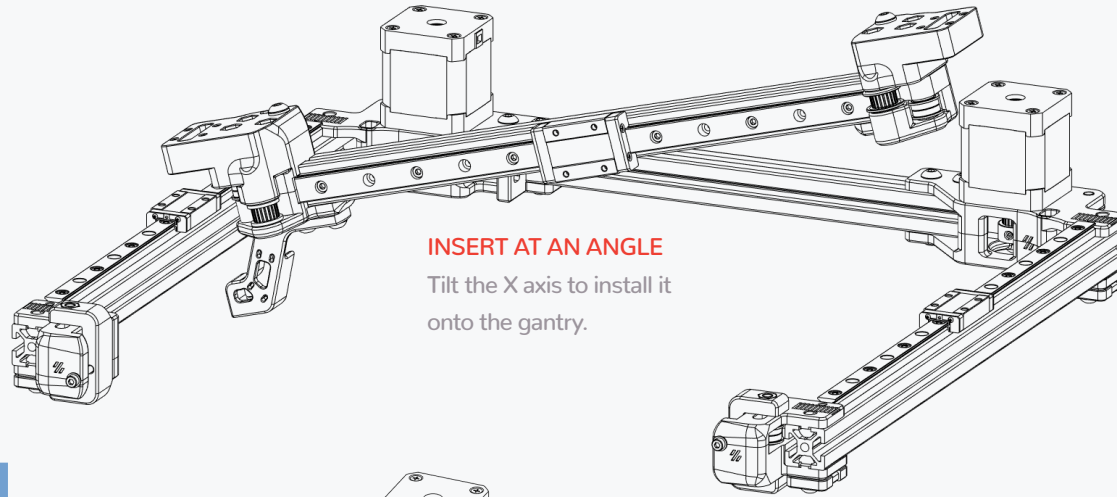

INSERT AT AN ANGLE

Tilt the X axis to install it onto the gantry.

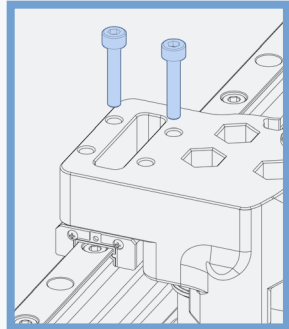

2X BOLT ONLY

The remaining bolts will be installed in a later step.

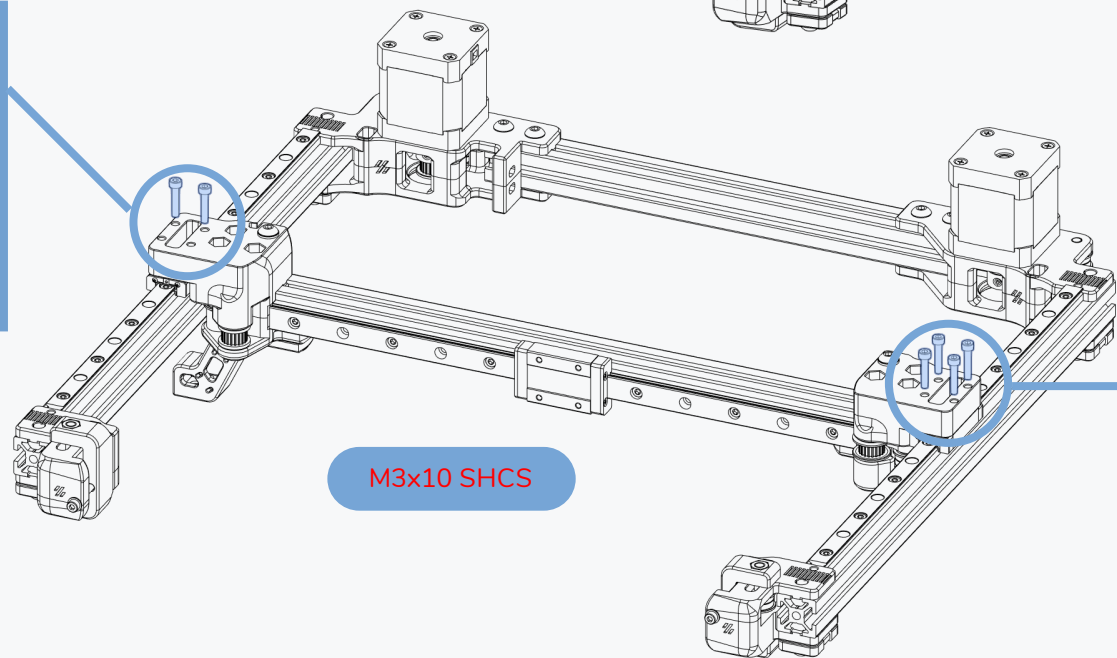

M3x10 SHCS

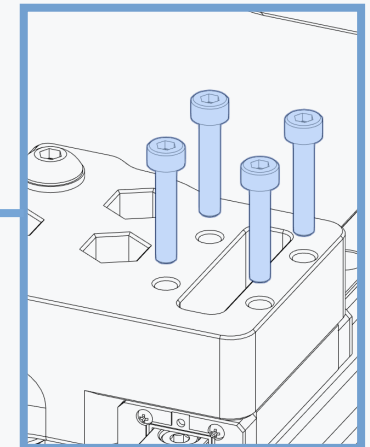

X CARRIAGE

WWW.VORONDESIGN.COM

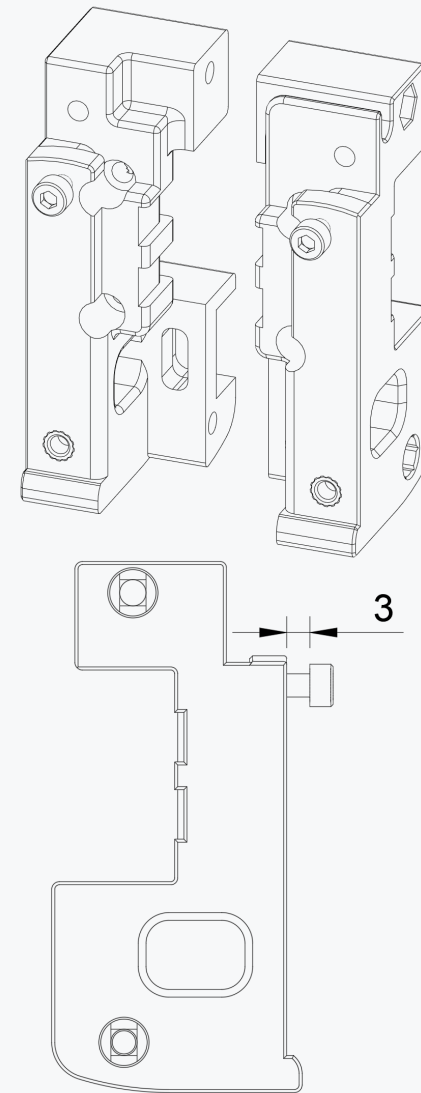
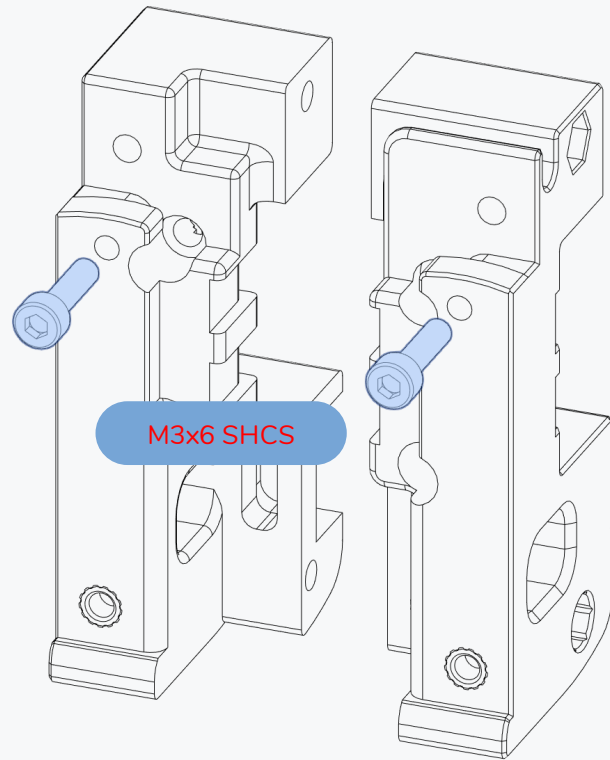

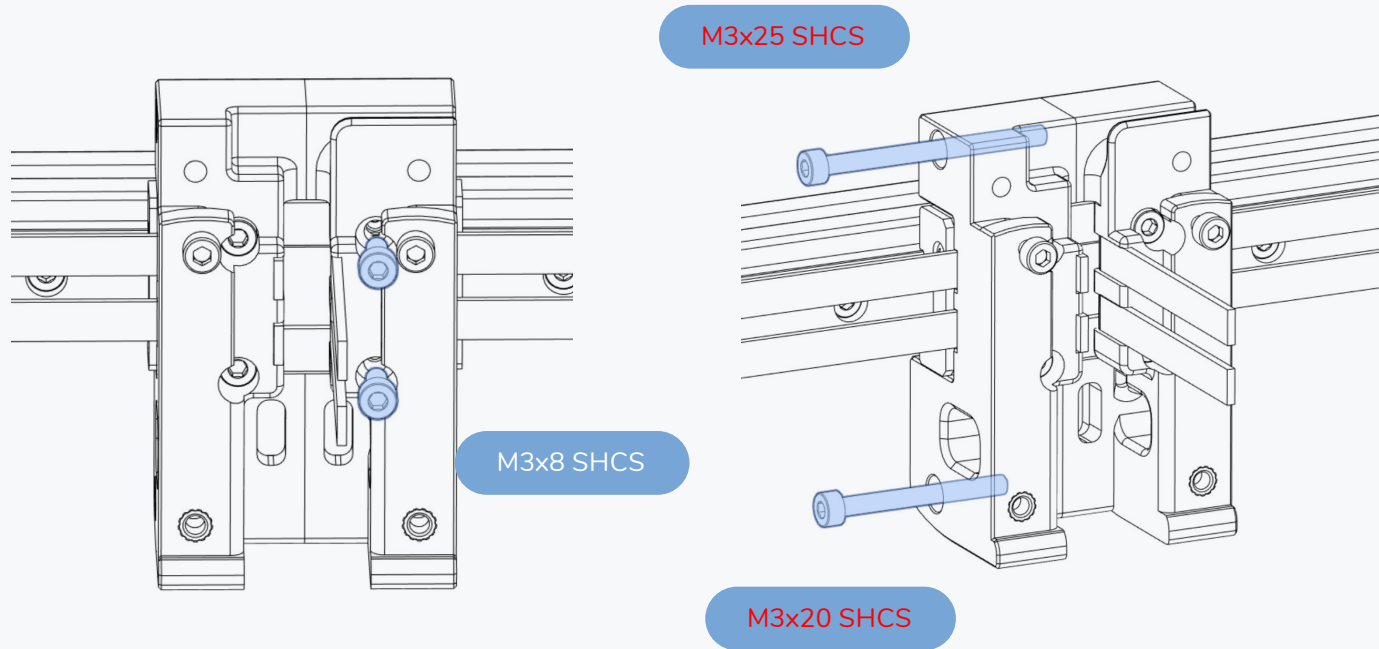

FIX BELTS

Lightly tighten the screws.
The belt must still be able to move.

LEAVE LOOSE

Lightly tighten the bolts.

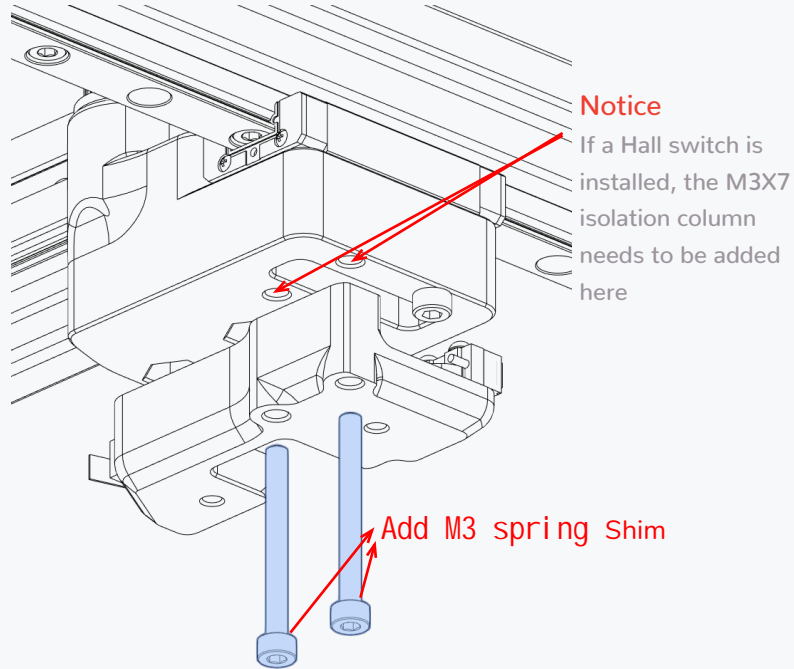

M3x25 SHCS

