

Enabling Automatic Filtering

By enabling this feature, Beam Air can automatically turn on when laser cutting starts and off when finishes.

Connect Beam Air and a FLUX laser cutter with the USB-B cable.

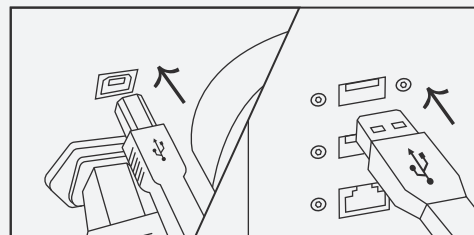

Once laser cutting starts, Beam Air will begin filtering.

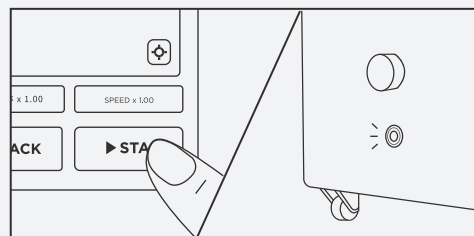

*** For automatic filtering, make sure not to turn on Beam Air manually.**

Filter Replacement

Filters should be placed in the orders shown below. Please note the lifespan for each layer is different and should be changed accordingly. All filters are available for purchase on FLUX's website.

Unbuckle the top cover to replace layers of filters.

Pre-filter

Lifespan : 10 ~ 30 hr

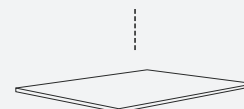

Medium efficiency filter

Lifespan : 50 ~ 150 hr

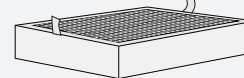

Activated charcoal filter

Lifespan : 300 ~ 600 hr

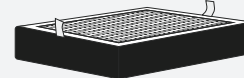

HEPA filter

Lifespan : 100 ~ 200 hr

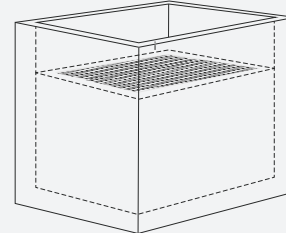

Product Content

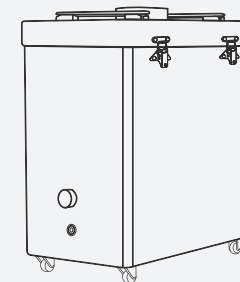

Beam Air x 1

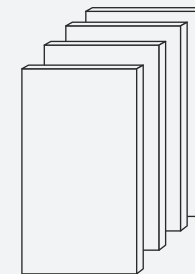

Pre-filter x 4

- Pre-filter x 1
- Medium efficiency filter x 1
- Activated charcoal filter x 1
- HEPA filter x 1

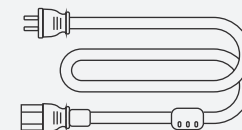

Power cable x 1

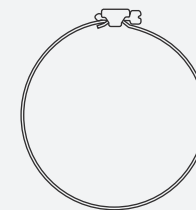

Hose Clamp x 1

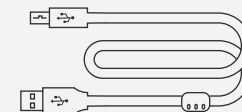

USB-B cable x 1



Get Started with Beam Air

Plug in the power cable to the power socket on Beam Air and connect to a power source.

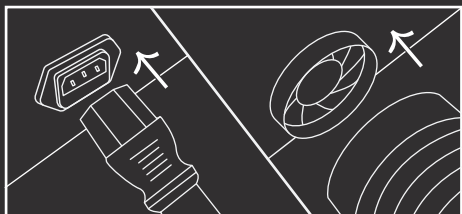

Connect the larger end of the exhaust hose to your laser cutter and tighten the hose clamp.

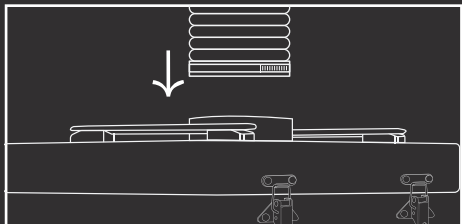

Connect the other end of the exhaust hose to Beam Air's air inlet and tighten the hose clamp to secure the installation.

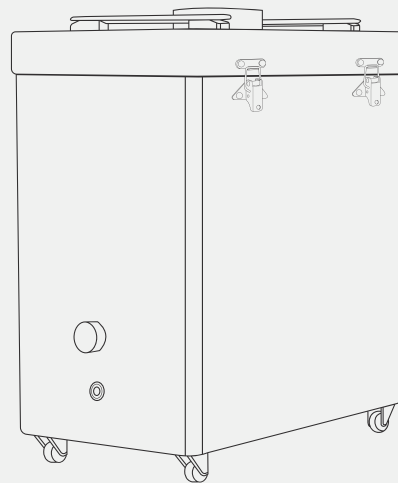

Hello FLUXer



Contact us

FLUX Inc.
<https://flux3dp.com/>



@flux3dp



@flux_inc



@flux3dp

Beam Air

Instructions